



# LED

PN: B334V30W30BN

**Thank you for purchasing Bright33™ LED Lighting Fixtures!**

#### TROUBLESHOOTING:

- Check that line voltage at fixture is correct.
- Ensure that there is voltage at lamp fixture wires. If there is no voltage, then check all connections.
- Check that fixture is grounded properly.

#### If fixture does not light:

- Check switch to ensure that there are no defects.
- Do not open fixture to clean LED. Do not touch the LED.
- Check fuse/circuit breaker for trips, then check wiring connections.

#### CLEANING AND MAINTENANCE:

**CAUTION:** Ensure fixture temperature is cool enough to touch. DO NOT clean or perform maintenance while fixture is energized.

- Clean lens and fixture with non-abrasive cleaning solution.
- Do not open fixture to clean LED. Do not touch the LED.
- Do not spray liquid directly on to LED, LED driver or wiring.

**Please read carefully before installing fixture.**

Save these instructions, as you may need them at a later date.

Please follow the following steps for installation. →

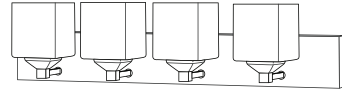

## BRIGHT33™ TRANSITIONAL 30" 4 LAMP VANITY LIGHT FIXTURE

### INSTALLATION INSTRUCTIONS

1-800-316-2532

www.bright33.com

### WARNINGS:



Turn power off before installation, inspection, or removal. Use all necessary precautions while performing this procedure.



Consult a qualified electrician to ensure correct branch circuit conductor. Min 90°C supply conductors.



Properly ground electrical enclosure. IT IS IMPERATIVE THAT THE OUTLET BOX BE PROPERLY GROUNDED.



DO NOT REVERSE THE HOT AND NEUTRAL CONNECTIONS, OTHERWISE SAFETY WILL BE COMPROMISED.



This Integrated LED Fixture™ has no lamp/bulb to replace.

**GENERAL:** All electrical connections must be in accordance with local and National Electrical Code (N.E.C.) standards. If you are unfamiliar with proper electrical wiring connections, contact and obtain the services of a qualified electrician. Use UL or IEC approved wire only for input/output connections.

Remove fixture and mounting components from the box, and make sure that no parts are missing, by referencing the illustration in the illustration instructions.

**NOT DIMMING COMPATIBLE:** This product is NOT compatible with dimmers. Fixture performance could be compromised by wiring fixture with dimmer. DO NOT USE WITH DIMMER(S)!

Figure 1

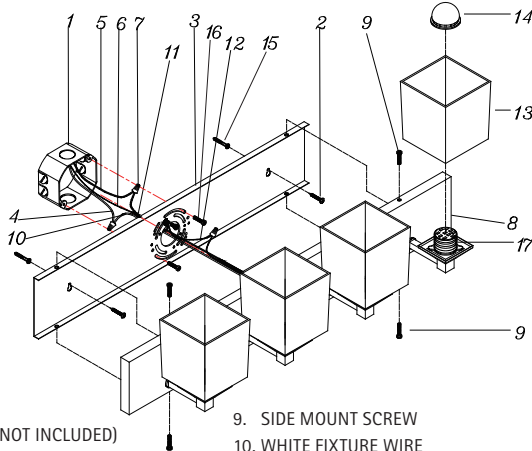

- |                              |                         |
|------------------------------|-------------------------|
| 1. OUTLET BOX (NOT INCLUDED) | 9. SIDE MOUNT SCREW     |
| 2. ANCHOR SCREW              | 10. WHITE FIXTURE WIRE  |
| 3. WALL PLATE                | 11. BLACK FIXTURE WIRE  |
| 4. WHITE SUPPLY WIRE         | 12. FIXTURE GROUND WIRE |
| 5. BLACK SUPPLY WIRE         | 13. GLASS SHADE         |
| 6. SUPPLY GROUND WIRE        | 14. RETAINING RING      |
| 7. WIRE NUT                  | 15. WALL ANCHOR         |
| 8. BACK PLATE                | 16. MOUNTING SCREW      |
|                              | 17. SOCKET MOUNT        |

**1 SHUT OFF MAIN ELECTRICAL SUPPLY FROM THE MAIN FUSE BOX/CIRCUIT BREAKER!**

**2** Remove contents from box. Ensure that no parts are missing. Reference the illustration included with this instruction manual.

**3** Place the WALL PLATE(3) over the OUTLET BOX(1). Mark the location of the keyhole slots on the wall, and remove the WALL PLATE(3).

**4** Drill a 1/4" hole at the on the wall.  
Carefully hammer a WALL ANCHOR(12) into the wall.

**5** Replace the WALL PLATE(6) over the OUTLET BOX(1) with the MOUNTING SCREW(16). Feed the ANCHOR SCREW(2) through the keyhole and thread into the WALL ANCHOR(15).

**6** Make the following wire connections (Fig.1), using the provided WIRE NUTS(7):  
WHITE (-) SUPPLY WIRE (4) TO WHITE FIXTURE WIRE (10)  
BLACK (+) SUPPLY WIRE (5) TO BLACK FIXTURE WIRE (11)  
SUPPLY GROUND WIRE (6) TO FIXTURE GROUND WIRE (12)  
If necessary, wrap all wire connections in electrical tape to ensure a secure connection.

**7** Carefully tuck all wiring back into the OUTLET BOX(1).

**8** Attach the BACK PLATE(8) to the WALL PLATE(3). Secure using the enclosed SIDE MOUNT SCREW(9).

**9** Put the GLASS SHADE(13) through the SOCKET MOUNT(17), then secure with the RETAINING RING(14).

*Repeat as necessary.*

**10** Restore power at fuse box/circuit breaker. Check operation of Integrated LED Fixture™.

**11** Installation complete.

### 5-YEAR LIMITED WARRANTY

**LIMITED WARRANTY:** Bright33™ Light Fixtures are warranted to be free and clear of defects in materials and workmanship for a period of five years from the date of purchase based on three hours of average usage per day for seven days a week. This warranty covers defects in manufacturing discovered while using the product as recommended by the manufacturer and does not apply to failures caused by acts of God or as a result of any abuse, misuse, abnormal use, or use in violation of any applicable standard, code, or instructions for use in installations.

If a Light Fixture fails due to a defect covered by this warranty, Stream33 Products LLC will replace the product. To make a warranty claim, retain the failed products and send with proof of purchase, register receipt, your name and address to the following address within thirty (30) days of the failure

Bright33 is a subsidiary of  
Stream33 Products LLC  
350 Courtney Road  
Sebring, Ohio 44672 USA

